

# Operating and safety instructions.

Fanlight with motor.

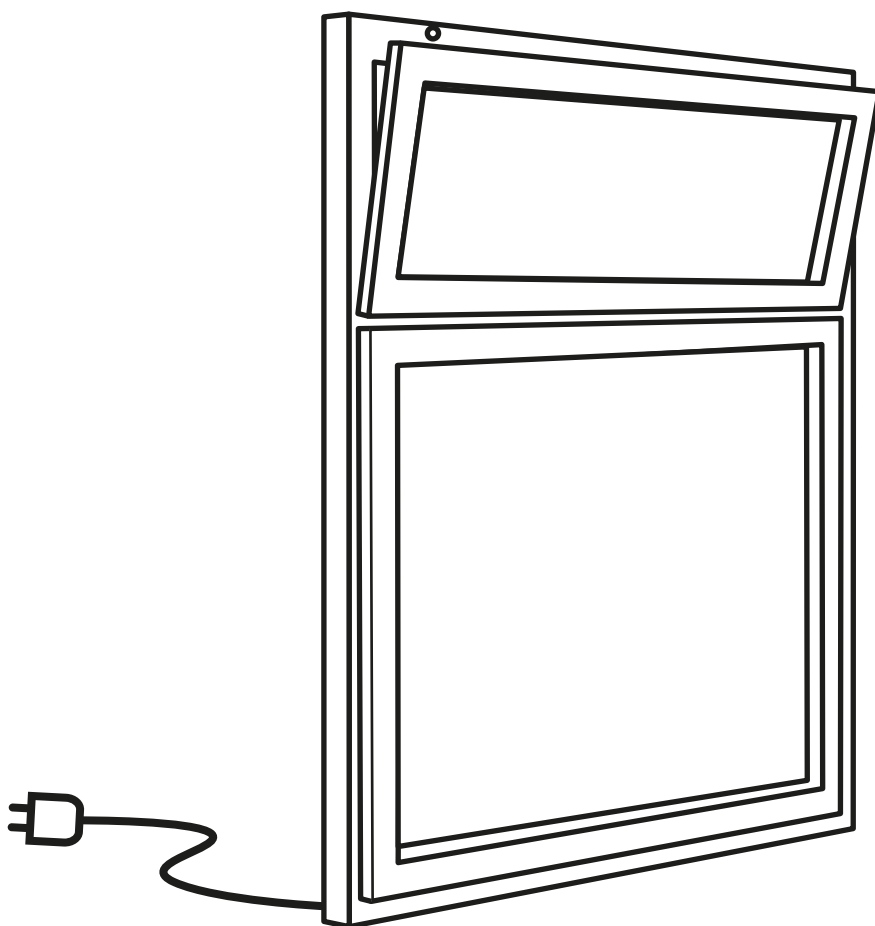



# Contents

## **Fanlight: motor concealed (tilting fittings)**

|                       |   |
|-----------------------|---|
| Component description | 4 |
| Safety instructions   | 4 |
| Wall switch           | 5 |
| Radio remote control  | 8 |

## **Fanlight: motor overlying (tilting fittings)**

|                      |    |
|----------------------|----|
| Wall switch          | 11 |
| Radio remote control | 11 |

## **Identifying and solving problems**

For further information on the operation and care of our Finstral products, please refer to the instructions in our document “Operating and safety instructions. Windows.” You can find it at: [finstral.com/manuals](http://finstral.com/manuals)

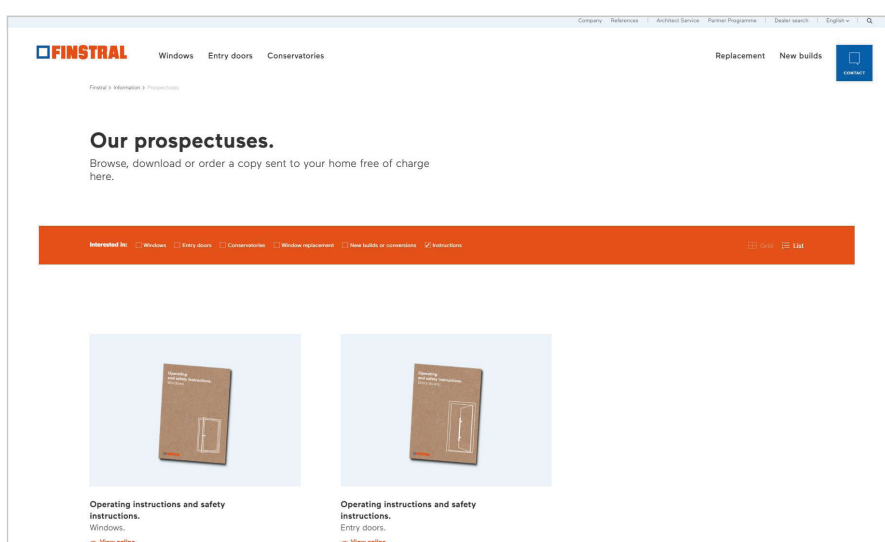

# *Fanlight: motor concealed (tilting fittings)*

## *→ Component description*

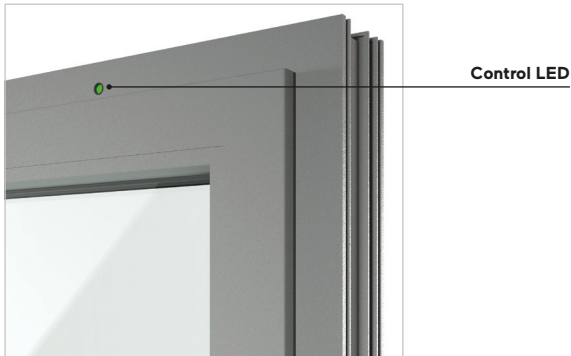

## *→ Safety instructions*

- If the window closure is motor-driven, do not push it by hand. If the window tilting or opening is motor-driven, do not pull the element by hand. The chain drive could be damaged.
- Keep the lever in a safe place. It is required in case of manual emergency operation.



### **Safety and cleaning instructions**

Further safety instructions and general information on window cleaning can be found in the instructions for use for windows ("Operating and safety instructions. Windows.") at: [finstral.com/manuals](http://finstral.com/manuals)

## → Wall switch

### Window in tilt position

*This is how you bring the window into the tilt position via the wall switch.*

#### Opening via the key

1. Press the "Open" key 1 time.

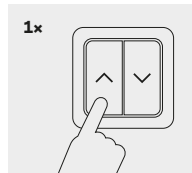

2. The LED lights up green.

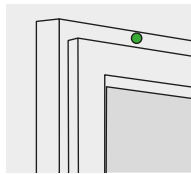

3. The window tilts independently in several seconds. As soon as the window is fully tilted, the green LED goes off.

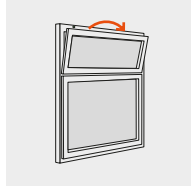

#### Closing via the key

1. Press the "Close" key 1 time. The window closes independently over several seconds.

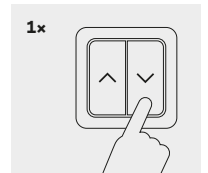

2. When the window is completely closed, the green LED flashes briefly.

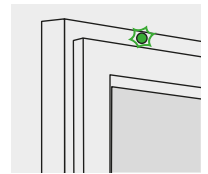

# Fanlight: motor concealed (tilting fittings)

## → Wall switch

### Closing the window in the tilt position via the auto lock function

As soon as the window is tilted or pushed shut, the fittings automatically engage and lock the window independently. The auto lock function is inactive in the event of a power failure. If the window is not pressed properly or is blocked or the window tilts back, the drive tries to lock up to 4 times. However, if the window is shut but has not been locked correctly, the locking mechanism will retract without further attempts. In this case, first open or tilt the window completely once again. The motor-driven locking mechanism then becomes active again.

1. Press the window. The drive beeps 1 time.

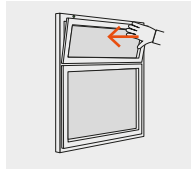

2. The window closes and locks independently. The green LED lights up briefly as soon as the window is in again the fully closed position.

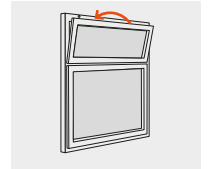

### Window in 10-minute tilt position

With the 10-minute tilt position, the window tilts independently and closes after 10 minutes. This setting is useful if you want to ventilate the room via a tilted window for 10 minutes.

1. Press the "Open" key 2 time.

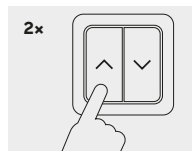

3. The window is in the tilt position for 10 minutes. The LED flashes green.

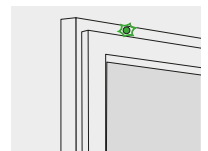

2. The green LED lights up, the window tilts independently.

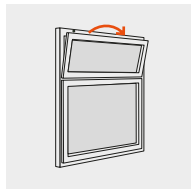

4. After 10 minutes, the window closes and locks independently. The green LED lights up briefly. The window is then in the closed position.

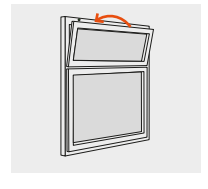

## Reference run

*The reference run brings the element to the starting position. The element can then be operated.*

**1.** The LED flashes red. The element beeps 20 times.

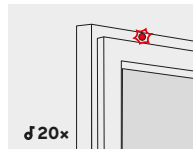

**3.** The reference run starts. It lasts about 30 seconds.

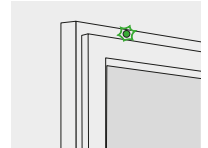

**2.** Press the "Close" key 1 time. The LED then flashes green briefly.

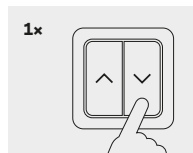

## Manual emergency operation

*With manual emergency operation, the tilt commands via motor-driven components are inactive. Manual emergency operation is carried out via the milling in the sash frame and may only be carried out by qualified personnel. Therefore, if necessary, contact the technical service of the installation company and under no circumstances carry out the manual emergency operation yourself.*

# Fanlight: motor concealed (tilting fittings)

## → Radio remote control

### Remote control

You have either a 1-channel or a 5-channel remote control.

#### 1-channel remote control



#### 5-channel remote control



#### The channels of the 5-channel remote control

There are five different channels. When you press the channel selector switch, you can see which channel you are in. The first four channels are identified by the individual LEDs. The fifth can be identified by the fact that all four LEDs light up. You can change the channel by pressing the channel selector switch again.

| LED status display lighting scheme |           |
|------------------------------------|-----------|
| 1                                  | • • • • • |
| 2                                  | • • • • • |
| 3                                  | • • • • • |
| 4                                  | • • • • • |
| 5                                  | • • • • • |

#### Same channel – multiple elements

You can programme several motor-driven elements on the same channel. For example, you can save and operate two windows on channel 1 and three other windows on channel 2.

#### Reach

The range of the remote controls is up to 40 metres and depends on whether the communication path between the element and the remote control is free or whether there are obstacles (walls etc.) in between. The fewer obstacles there are between the remote control and the element, the further the signal will reach.



## Operation

If you have a 5-channel remote control, make sure that the correct channel is selected in which the item(s) to be operated is stored before operating it by pressing the channel selector switch.

### "Tilt" and "Close" keys

Briefly pressing the "Tilt" key tilts the window completely.



Briefly pressing the "Close" key closes the element completely.



### The stop function

The element is in motion. Press the "my" key briefly to stop the element. By pressing the "my" key again, the element continues to move in the direction it was moving before it stopped.



### Adding a remote control via a taught remote control

If you have motor-driven window that can be operated via a remote control, you can teach-in another of the same type via an already saved remote control.

1. With a remote control that has already been saved, press the programming key (prog) for approx. 2 seconds.



2. If you want to add a 5-channel remote control, first select the desired channel via the channel selector switch. Press the programming key (prog) on the remote control to be added for approx. 2 seconds. The remote control is added.



### Deleting a remote control via a taught remote control

If you have motor-driven window that can be operated via a remote control, you can delete another via an already saved remote control.

1. With a remote control that has already been saved, press the programming key (prog) for approx. 2 seconds.



2. If you want to delete a 5-channel remote control, first select the desired channel via the channel selector switch. Press the programming key (prog) on the remote control to be deleted for approx. 2 seconds. The remote control is deleted.



# Fanlight: motor concealed (tilting fittings)

## → Radio remote control

### Adding a channel with the 5-channel remote control

Make sure the remote control is on the correct channel. To do this, press the channel selector switch, which shows you which channel the remote control is on, and set the correct channel if necessary. Then proceed in the same way as for adding a remote control (see page 9).



### Information

It is not possible to delete only one channel on a 5-channel remote control. Only the entire remote control can be deleted.

### Replacing the battery

If you need to replace the battery, proceed as follows.

1. Unscrew the cover of the remote control as shown in the illustration.



2. Push the empty battery carefully out of the compartment with a plastic object or a screwdriver.



3. Insert a new battery (type CR 2032 3V) into the holder so that the side with the plus sign is visible. Take into account the polarity. The connections must not be short-circuited. Push the battery into the compartment.



4. Refit and screw on the cover.



### Wall holder for remote control

The wall bracket is used to attach the remote control to the wall. Here you can find out how to attach it to the wall.

1. Remove the protective film from the adhesive surface on the back of the wall bracket.



2. Attach the wall bracket to a smooth, clean and dry surface. Press it firmly so that it sticks well.



3. Place the remote control on the wall bracket.



# Fanlight: motor overlying (tilting fittings)

## → Wall switch

### Opening via the key

Press the "Open" key 1 time. The window tilts independently in several seconds.

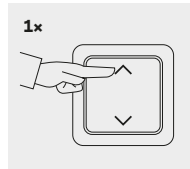

### Closing via the key

Press the "Close" key 1 time. The window closes independently over several seconds.

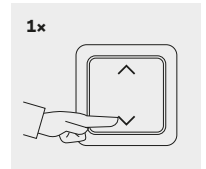

## → Radio remote control

### Operation with the radio remote control

The operation of a fanlight with an overlying motor via a radio remote control corresponds to that of a fanlight with a concealed motor via a radio remote control. Therefore, refer to the contents on pages 4–10.



### Safety and cleaning instructions

Observe the notes on the fanlight with a concealed motor on page 4. Further safety instructions and general information on window cleaning can be found in the instructions for use for windows ("Operating and safety instructions. Windows.") at: [finstral.com/manuals](http://finstral.com/manuals)

# Identifying and rectifying problems

| Problem   | Cause  | Solution   |
|---|--|--|
| <b>The fanlight with a concealed motor beeps several times and stops. The LED flashes continuously.</b>   | high wind pressure   | Wait until the wind pressure decreases.  |
|   | draught  | Eliminate the cause of the draught.  |
|   | The fittings are blocked or too stiff.                       | If necessary, remove the blockage or contact the installation company's technical service. |
|   | power failure  | Remedy the voltage failure and perform a reference run.                                    |
| <b>The fanlight with an overlying motor beeps several times and tries up to three times to slowly move to the "Close" position. (After the third attempt, the drive stops). The LED flashes continuously.</b> | high wind pressure   | Wait until the wind pressure decreases.  |
|   | draught  | Eliminate the reason for the draught.  |
|   | The fittings are blocked or too stiff.                       | If necessary, remove the blockage or contact the installation company's technical service. |
| <b>The fanlight with motor shows no reaction when the push-button or the remote control is operated.</b>  | no power supply  | Check the power supply.  |
|   | The wiring is incorrect/defective or the cable is defective. | Contact the technical service of the installation company.                                 |
|   | The power supply unit is faulty/defective.                   |  |
|   | The battery of the radio remote control is low.              | Replace the battery.   |

| Problem  | Cause  | Solution   |
|--|--|--|
| <b>The fanlight with motor does not tilt or close.</b> | There is no power supply.                                  | Check the power supply.  |
|  | The fittings are blocked or too stiff.                     | If necessary, remove the blockage or contact the installation company's technical service. |
|  | The fittings are too smooth-running.                       | Contact the technical service of the installation company.                                 |
|  | The drive is dirty.  | Check the drive for dirt and clean it if necessary.  |
|  | Especially during tilting: The fanlight is already tilted. | Check the position of the window sash.   |
|  | Especially when closing: The fanlight is already closed.   |  |

**Copyright**

© Finstral AG, Unterinn/Ritten, 2023  
All rights reserved.

The Finstral logo is a registered image mark of Finstral AG.  
The name "Finstral" is a registered word mark of Finstral AG.

**Edition May 2023**

Item number 60-0309-00-07

Subject to technical changes. Colour may differ from original products owing to printing processes. The presentation and description of the products in the prospectuses are for indicative purposes only. Should the product delivered deviate in any way from the product appearing in the advertising material, this shall not constitute any defect or deviation as only the order may be used as a benchmark.



# Always there for you. Call us or call in.

**Finstral Studio Unterinn**

Headquarters, 600 m<sup>2</sup> exhibition  
Unterinn/Ritten, Italy

**T +39 0471 296611**

**[finstral.com/unterinn](https://finstral.com/unterinn)**

**Finstral Studio Friedberg**

Showroom, 1,000 m<sup>2</sup> exhibition  
Derching/Friedberg, Germany

**T +49 821 2071780**

**[finstral.com/friedberg](https://finstral.com/friedberg)**

**Finstral Studio Apeldoorn**

Showroom, 350 m<sup>2</sup> exhibition  
BN Apeldoorn, Netherlands

**T +31 055 5380060**

**[finstral.com/apeldoorn](https://finstral.com/apeldoorn)**

**Finstral Studio Wihr-au-Val**

Showroom, 350 m<sup>2</sup> exhibition  
Wihr-au-Val, France

**T +33 03 89717100**

**[finstral.com/wihrauval](https://finstral.com/wihrauval)**

**Finstral Studio Tarragona**

Showroom, 320 m<sup>2</sup> exhibition  
43144 Vallmoll - Tarragona, Spain

**T +34 977 637001**

**[finstral.com/tarragona](https://finstral.com/tarragona)**

**Finstral Studio Crissier**

Showroom, 180 m<sup>2</sup> exhibition  
Crissier, Switzerland

**T +41 021 8861240**

**[finstral.com/crissier](https://finstral.com/crissier)**

**Finstral Studio Brussels**

Showroom, 600 m<sup>2</sup> exhibition  
Zaventem, Belgium

**T +32 02 616 09 17**

**[finstral.com/brussels](https://finstral.com/brussels)**

**Finstral Studios in your vicinity:**

**[finstral.com/dealer-search](https://finstral.com/dealer-search)**